

Cloud Pak for Data 4.8

—
Product Management
Data & AI

Cloud Pak for Data 4.8 – The Platform

Cloud Pak for Data platform delivers the must have foundational capabilities for a robust enterprise grade system which is table stakes for top Tier-1 companies.

It's all about having the right tools to access the right data at the right time. Cloud Pak for Data platform strives to bring this notion to reality with its 40+ services for accessing and leveraging data efficiently, ensuring security and connectivity.

Cloud Pak for Data 4.8 continues to focus on Enterprise Readiness, Security & Connectivity for production deployments. Additional focus on quality fixes and security vulnerability patches in monthly releases.

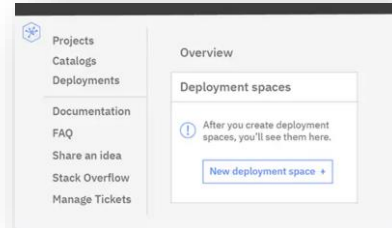

Built for Multi-cloud

Avoid vendor lock-in & get started on your cloud journey today

PICK YOUR ADD-ON

Containerized Services



DATA & AI PLATFORM

#1 Ranked by Forrester



KUBERNETES BASED

Containerized, easy to manage



PICK YOUR CLOUD

Private or Public



My virtualized data

<input type="checkbox"/> Table	Schema	Created on
<input type="checkbox"/> RANKING_RESULTS	EMPLOYEE	Sep 27,2021
<input type="checkbox"/> TRAINING_DETAILS	EMPLOYEE	Sep 27,2021
<input type="checkbox"/> EMPLOYEE	EMPLOYEE	Sep 27,2021
<input type="checkbox"/> EXPENSE_DETAIL	EMPLOYEE	Sep 27,2021

 **STORAGE**
15.78 KB used | File system

Evaluations



Cloud Pak for Data - What's New!

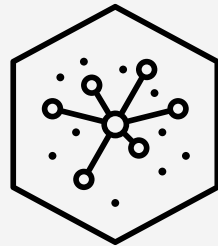

CP4D v4.8 GA – November 2023

14th CPD Feature Release, 4th 4.x Release

- Serviceability

- Out-of-the-Box Monitors – Basic Health Checks
- User Activity Monitoring
- Enhanced Diagnostic Log Collection
- CP4D k8s resource descriptions
- Install and Upgrade healthchecks

- Disaster Recovery Solutions

- Fusion DR recertification – 4.7.1
- NetApp using Astra Control Center
- Portworx using PWX-DR Utility

- Deployments

- Online Upgrades
- Footprint Reduction (CPU) – small_mincpureq
- IBM Power support
- CPD Scheduler Enhancements
- Turbonomic Integration

- Storage

- New IBM Storage Fusion Essentials offering – limited features, but with no additional costs
- Azure NetApp Files certification

- Security

- ABAC – Custom Attributes via API
- Expanded Vault Integration – Vault Bridge SDK
- Enhanced Authentication
- Minimum RBAC privileges for install and upgrade

- connectivity

- watsonx.data (New Connector – 4.7.3)
- Custom Connectors
- Kafka – IBM Event Streams schema registry support
- Teradata – SSL /TLS 1.2 and LDAP Authentication
- Oracle – SSO with Kerberos
- Azure SQL – Azure AD Authentication
- Google BigQuery – add'l support BQ table data-types
- Plus many more...

Cloud Pak for Data 4.8 Platform Features

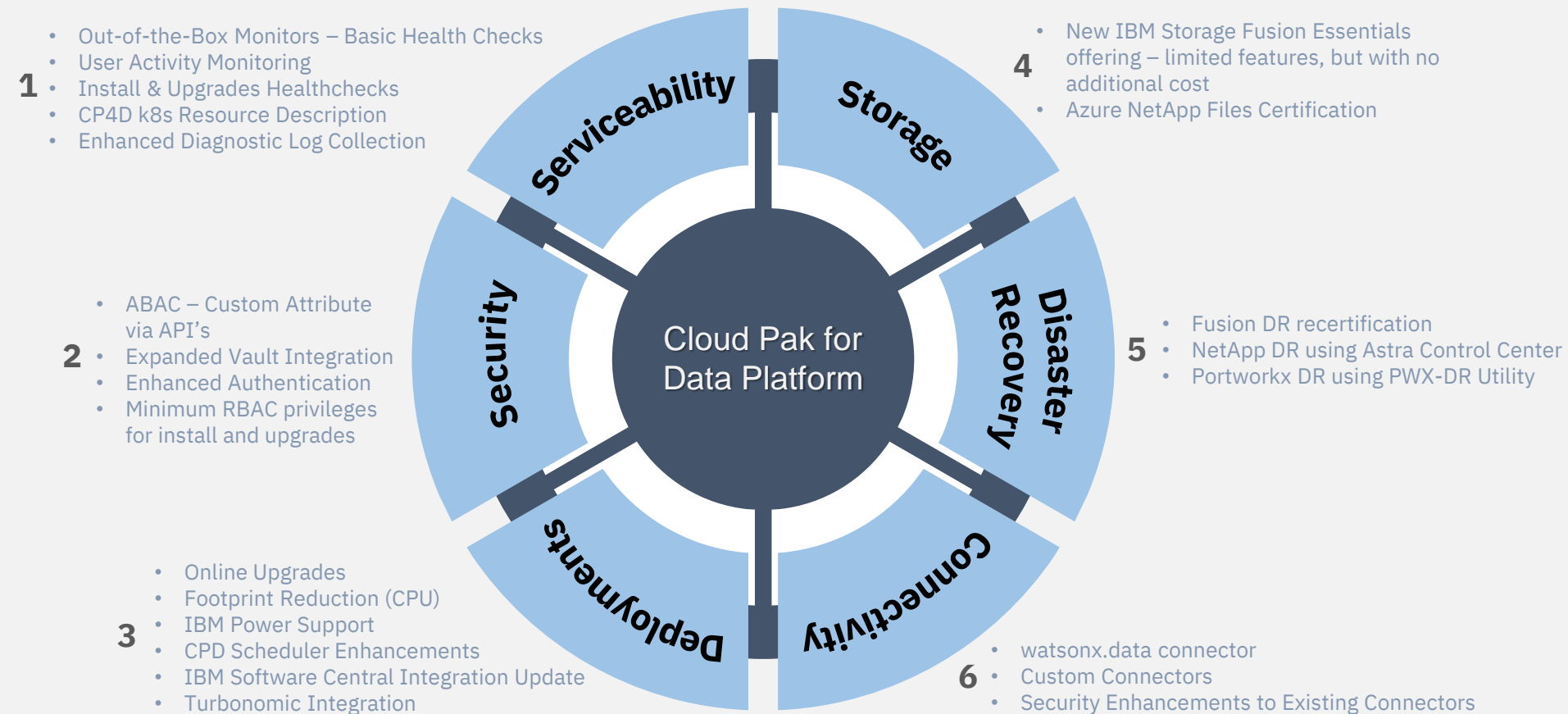

Investments in a **trusted data foundation** will accelerate and scale **AI**



Where to get more information on Cloud Pak for Data 4.8

Seismic Assets

Cloud Pak for Data Seismic Page:
[link pending]

Cloud Pak for Data 4.8 What's
New:
[link pending]

Cloud Pak for Data 4.8 Reference
Architecture:
[link pending]

BLOG

Cloud Pak for Data 4.8 blog
Internal Blog and External Blog

Miscellaneous Updates

4.8 Licensing Agreement Standard
Edition:
[link pending]

4.8 Licensing Agreement Enterprise
Edition:
[link pending]

Features Differences Documentation
(CP4D 4.7 versus CP4DaaS):
<https://dataplatform.cloud.ibm.com/docs/content/wsj/getting-started/feature-matrix.html?context=cpdaas>

